



Yamaha FRZ 750 R (OW01) (Tamiya 14058) – chain set

Catalog no.: FSM P011

Installation guide

Parts list: metal wire x 1, metal rod x3

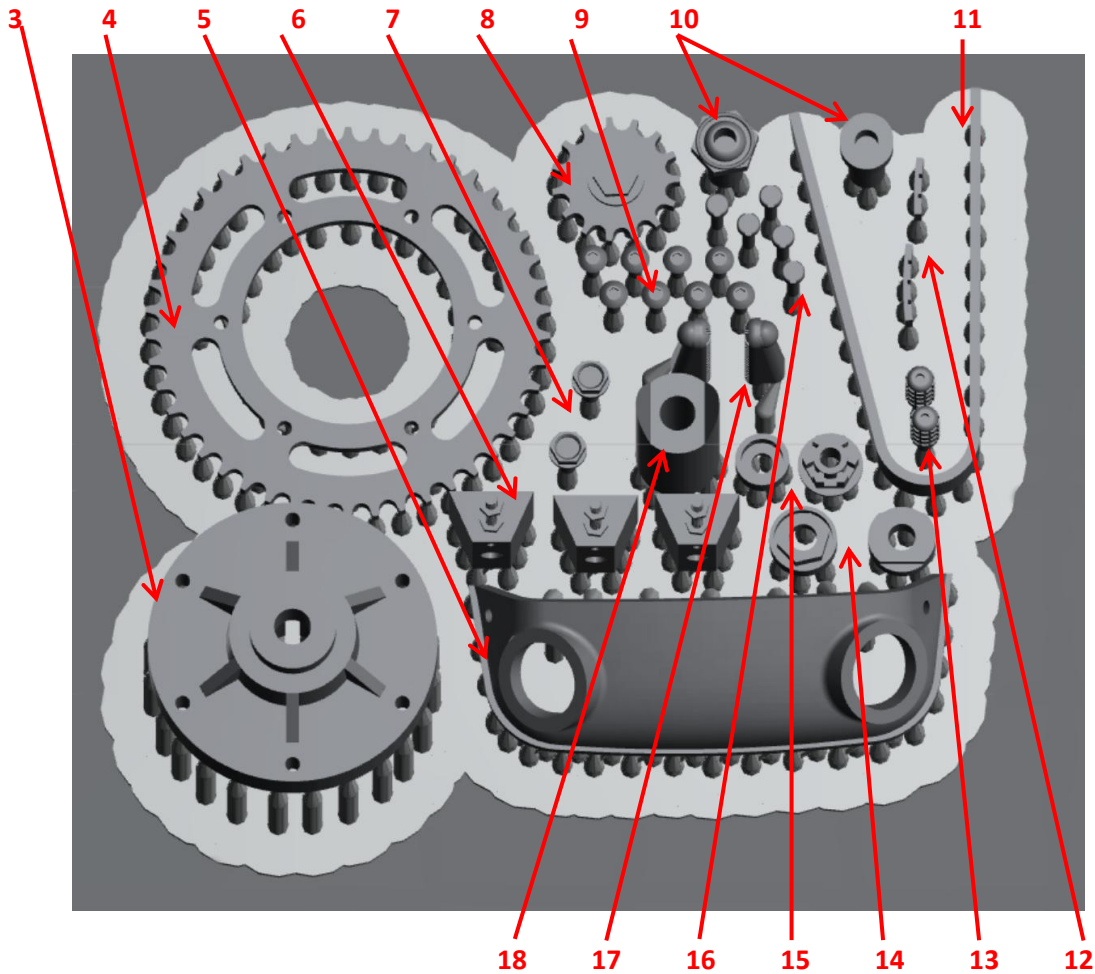
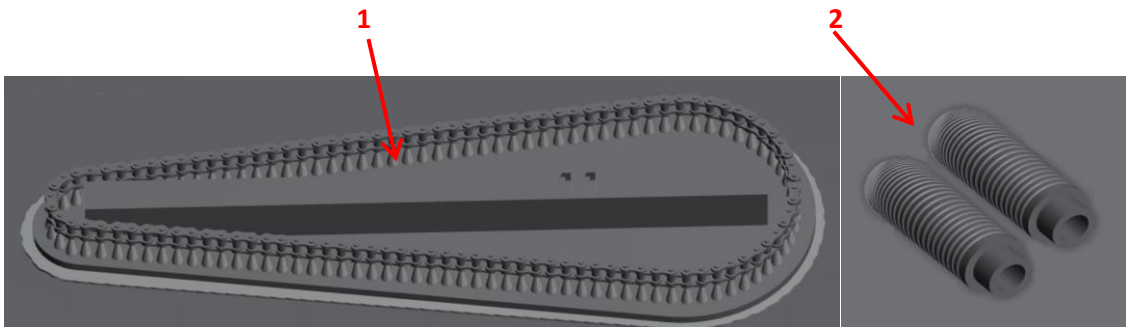

| Part no. | Part name | Part no. | Part name |
|-----------------|--------------------------|-----------------|-----------------------------|
| 1 | Chain x1 | 10 | Swingarm – frame screw x2 |
| 2 | Air duct x2 | 11 | Swingarm chain guard x1 |
| 3 | Rear sprocket adapter x1 | 12 | Rim counterweight x2 |
| 4 | Rear sprocket x1 | 13 | Brake/shifter peg x2 |
| 5 | Fuel tank cover x1 | 14 | Front wheel nut x2 |
| 6 | Chain tensioner x3 | 15 | Rear wheel nut x2 |
| 7 | Steering column screw x2 | 16 | Fuel tank cover screws x5 |
| 8 | Front sprocket x1 | 17 | Foot peg x2 |
| 9 | Rear sprocket screw x8 | 18 | Rear wheel axle cylinder x1 |

It is suggested to cut off all parts except screws which can be painted as attached to the print base.

Use CA glue to join resin parts with the ones from the base kit.

Contents

| | |
|------------------------------------|---|
| Chain..... | 3 |
| Air ducts and fuel tank cover..... | 4 |
| Other detailed parts | 5 |

Chain

Installation holes for axle (metal rod) 1.6 mm. Cut metal rod to the length of the corresponding screws

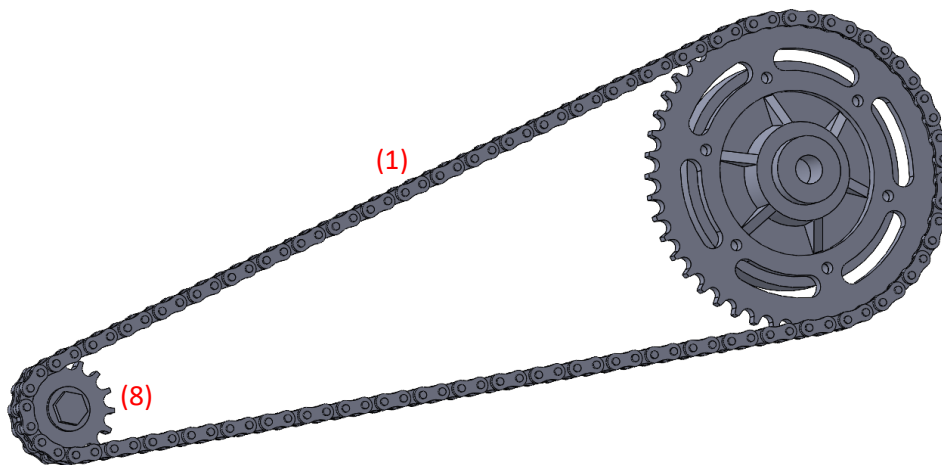
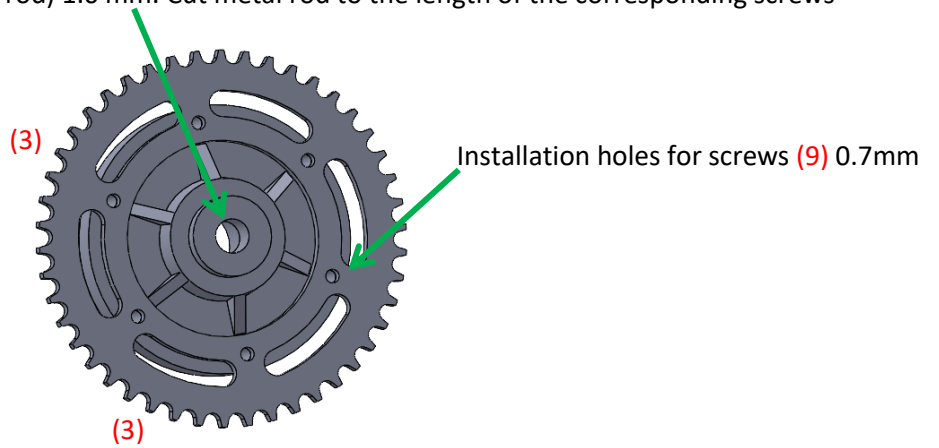

Air ducts and fuel tank cover

Adjust position of pipes to make them fit the bike.

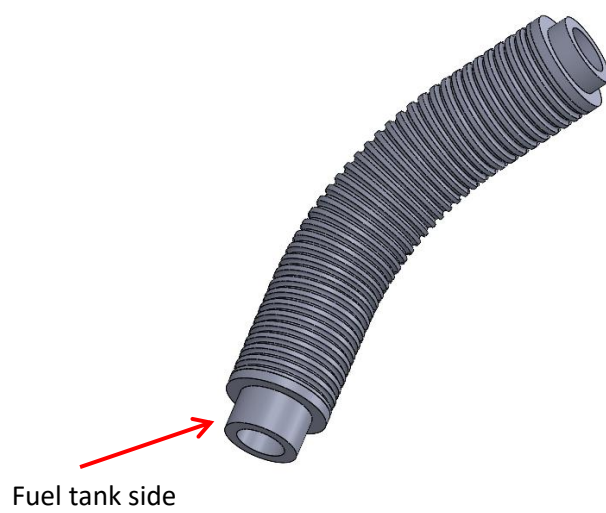
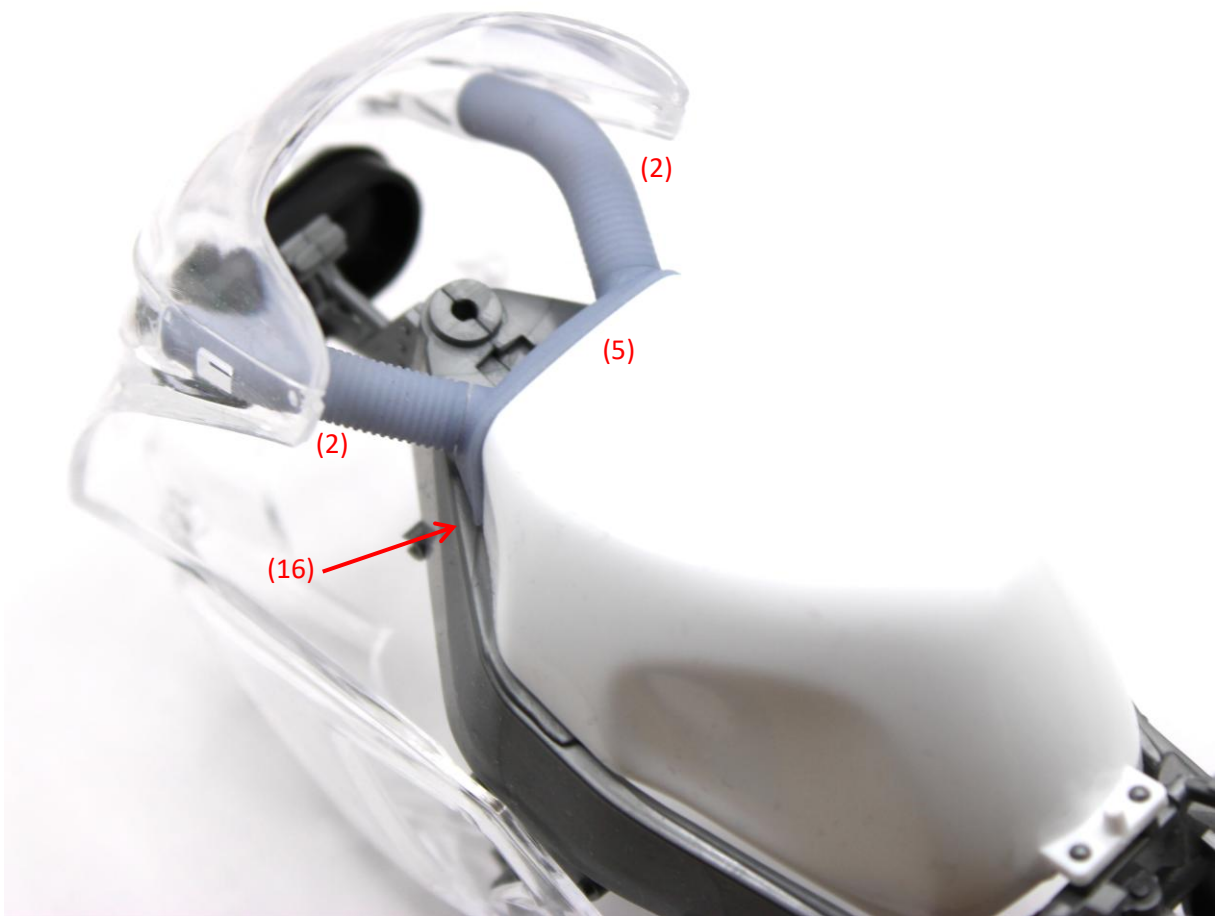

Other detailed parts

Screws from the base kit for front and rear wheels as well as for steering column can be replaced with metal rods. Installation hole diam. 1.6 mm. Adjust the length according to the screws.

Chain tensioner nut has holes through which metal wire should pass to recreate a locking cotter. Chain tensioner installation hole 0.6 - 0.7mm. Use rear wheel axle cylinder (18) to install the rear wheel.

Use front, rear and swingarm nuts installation use reference photos attached to the base kit.

Foot pegs installation holes 0.8 mm.

Install rim counterweights on the rims. Smaller for front, bigger for rear wheel.

Swingarm chain guard should be added to the swingarm on chain side.